



Pompeii

20 Apr 2018

Pompeii

From East to West: Approx. 1.5km

Bags Allowed: 30cm x 30cm x 15cm

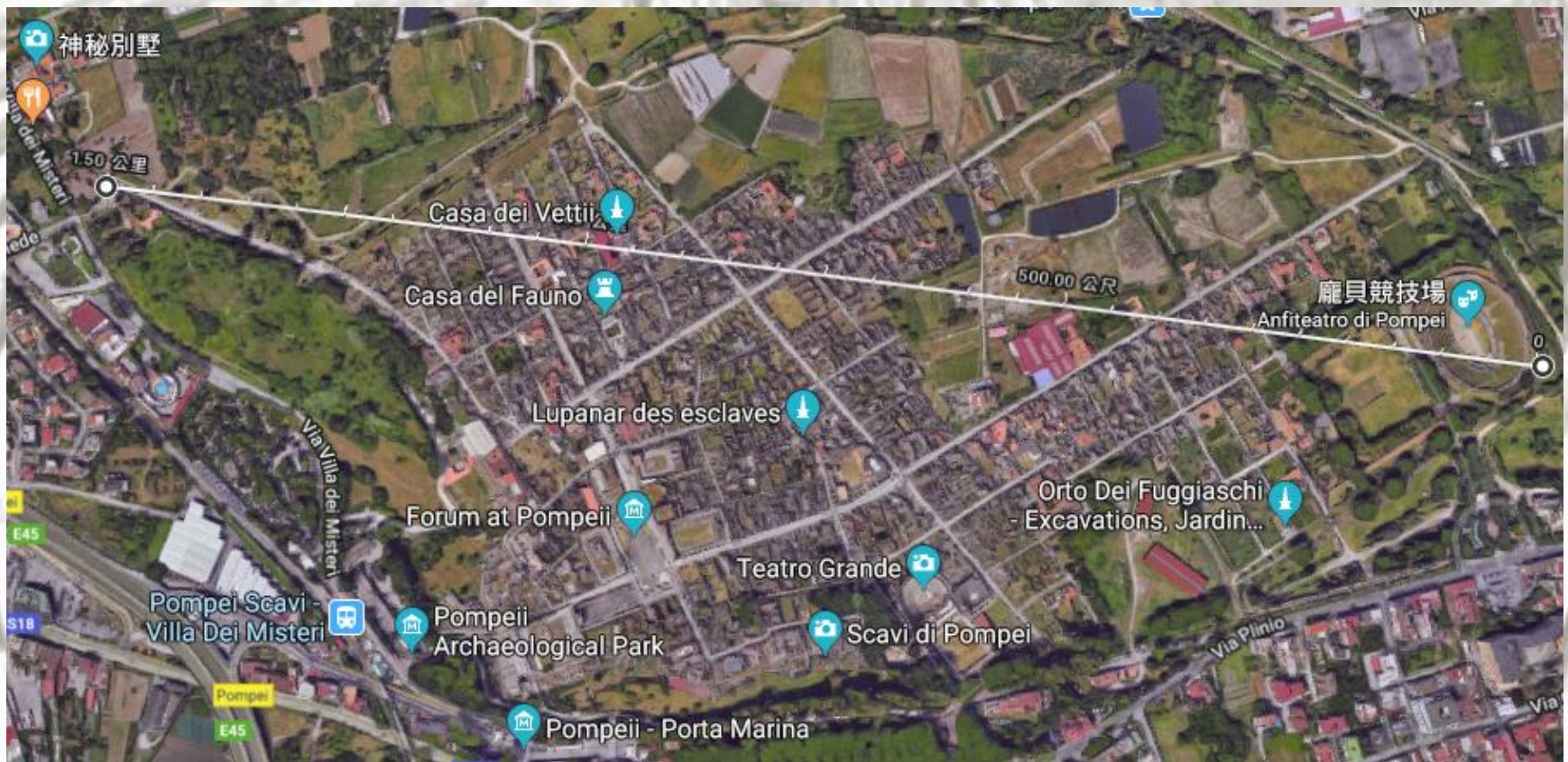

Pompeii

Divided into 9 Areas

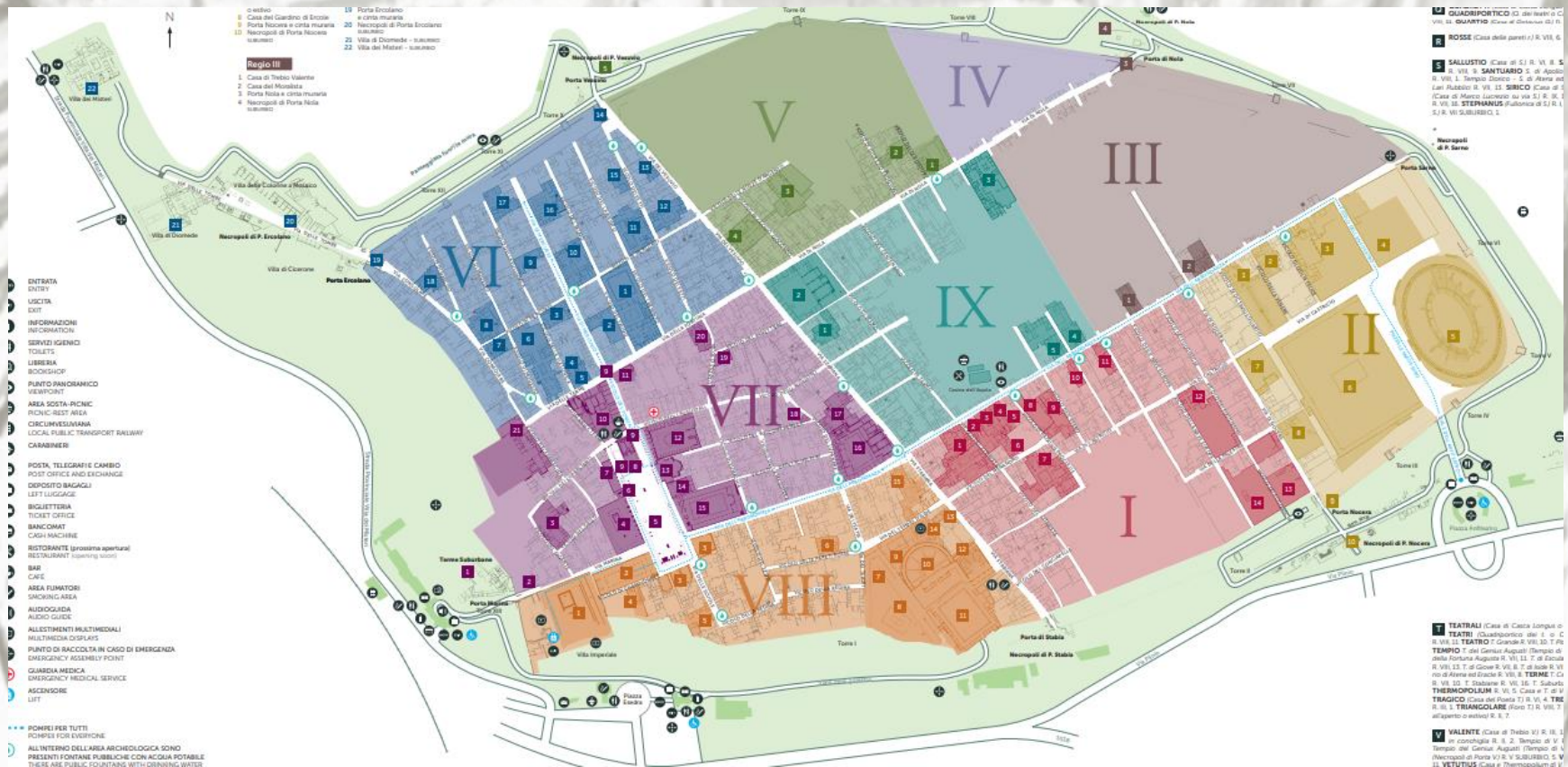







<http://pompeisites.org/allegati/Pianta%20degli%20scavi%20di%20Pompei%20-%20Plan%20of%20the%20excavations%20of%20Pompeii.pdf>

Pompeii

Suggested Highlights

All changes saved in Drive

 Add layer  Share  Preview

-  Amphitheatre of Pompeii
-  House of Menander - Excava...
-  Teatro Grande 
-  Casa dei Vettii
-  Casa del Fauno
-  Casa del Chirurgo
-  Villa dei Misteri
-  House of the Tragic Poet
-  Temple of Jupiter
-  Tempio di Apollo
-  Terme Suburbane
-  Diomedes's Villa
-  Villa Regina
-  Lupanar des esclaves



Pompeii

Amphitheatre of Pompeii

- The oldest surviving Roman amphitheatre
- The earliest Roman amphitheatre (70 BC) known to have been built of stone



Pompeii

Casa del Menandro (House of Menander)

- 1,800 Sq. M

Fresco

- well-preserved fresco of the ancient Greek Dramatist Menander in a small room
- other frescoes, including one depicting the death of Laocoon.

Classical style and Hellenism

- columns are representative of the Doric style of architecture.

Graffiti

- Numerous examples of Roman graffiti can be observed on the exterior walls of the house.



Pompeii

Terme Suburbane (Suburban Baths)

- public bath house to the residents of Pompeii (~100 BC)



Pompeii

Casa del Fauno (House of Faun)

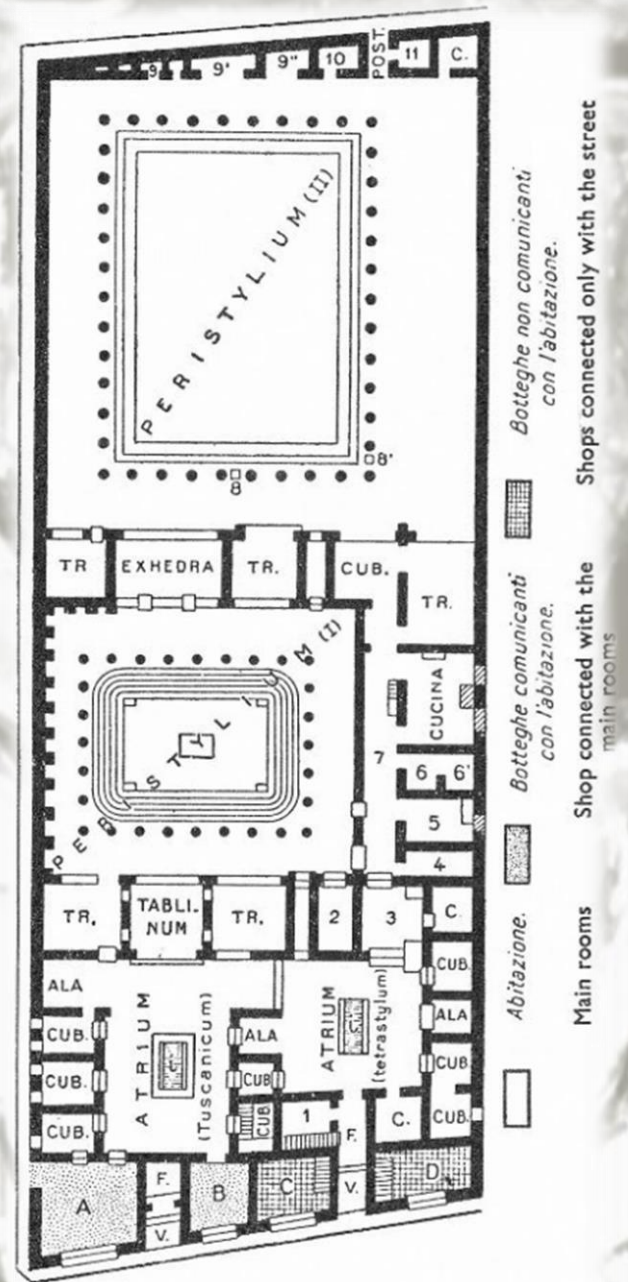

14. THE HOUSE OF THE FAUN, POMPEII

Pompeii

Villa dei Misteri (Villa of the Mysteries)

- Well preserved Roman Villa
- Most famous room in Pompeii
- Many Frescos

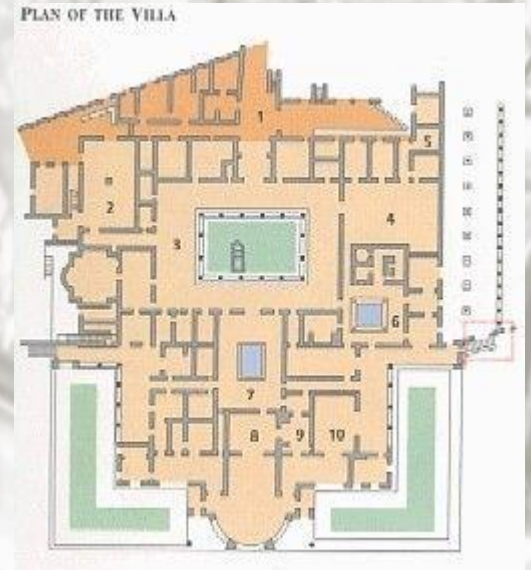

The background of the slide is a detailed charcoal or pencil sketch. In the foreground, there is a large, curved structure with prominent, dark, ribbed lines, resembling a large shell or a cross-section of a geological formation. To the right of this structure, there is a more solid, rectangular block. The background is filled with a dense, dark, and somewhat chaotic pattern of lines, suggesting a forest of tall, thin trees or a thicket of branches. The overall style is artistic and textured.

Pompeii

END